

Assembly Instructions HSDS-1

Sanitiser Stand & Dispenser



PARTS

Required
(not included)

4x AA Batteries
Screwdriver
Gel Sanitiser

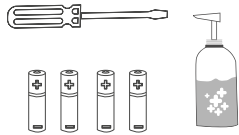

Included

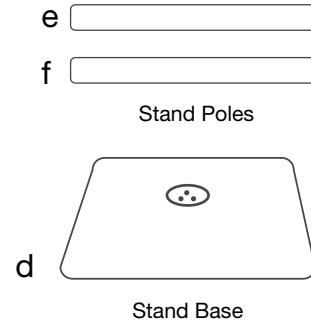
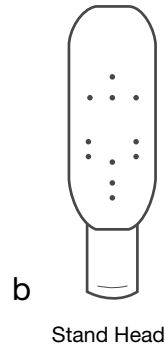
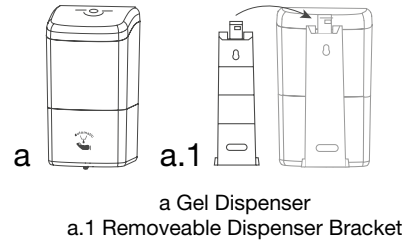

g Stand Base Screws (pre-attached on e)

h Twist mechanism screw (pre-attached on b)

i Dispenser Key

j Dispenser Mount Screws

k Connector screw

STEPS: STAND

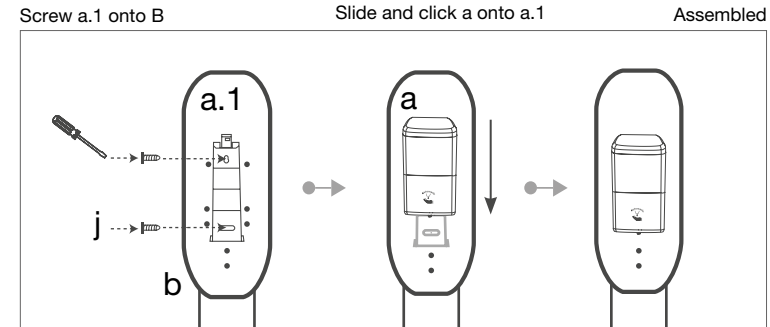
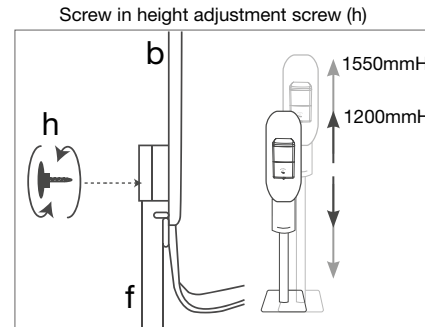
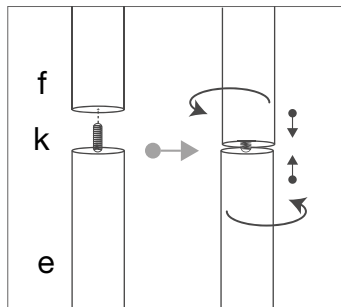
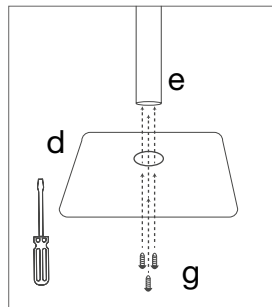

STEPS: DISPENSER

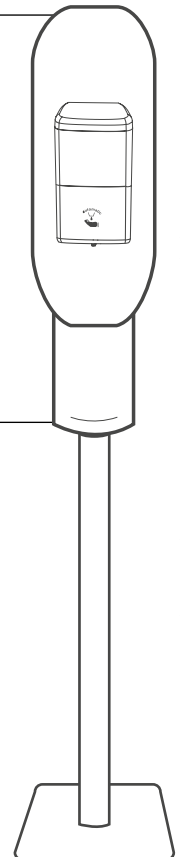
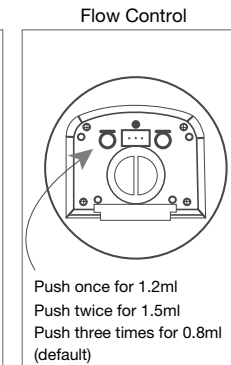
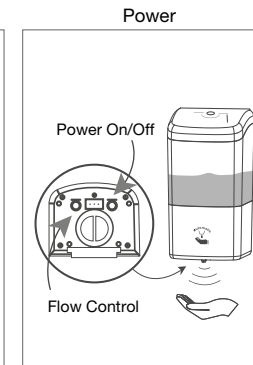
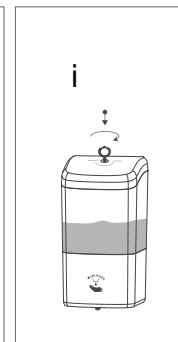
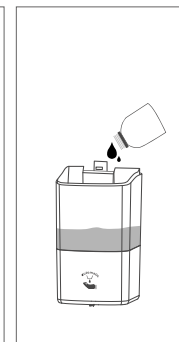
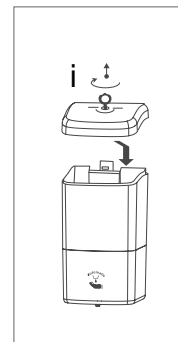
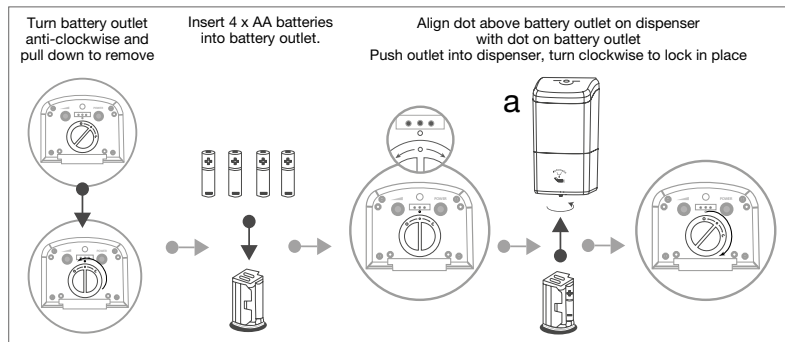

FINAL ASSEMBLED SANITISER STAND

Note: Designed for GEL Sanitiser ONLY. Use of other Sanitising Solutions other than GEL will differ amount dispensed.